

- NOTES:
1. Tension wire grid layed out in 10' x 10' sections.
  2. Onstage lighting pipes are hung below grid height.
  3. Uplights for cross pipes are situated at each intersection. Key-Klamp and 10'-6" pipes available.
  4. Telescoping platforms store directly under booths.
  5. Grid Height is 28'-0"
  6. Dressing rooms include toilets and showers
  8. Set load in on N.E. corner of building (overhead door)

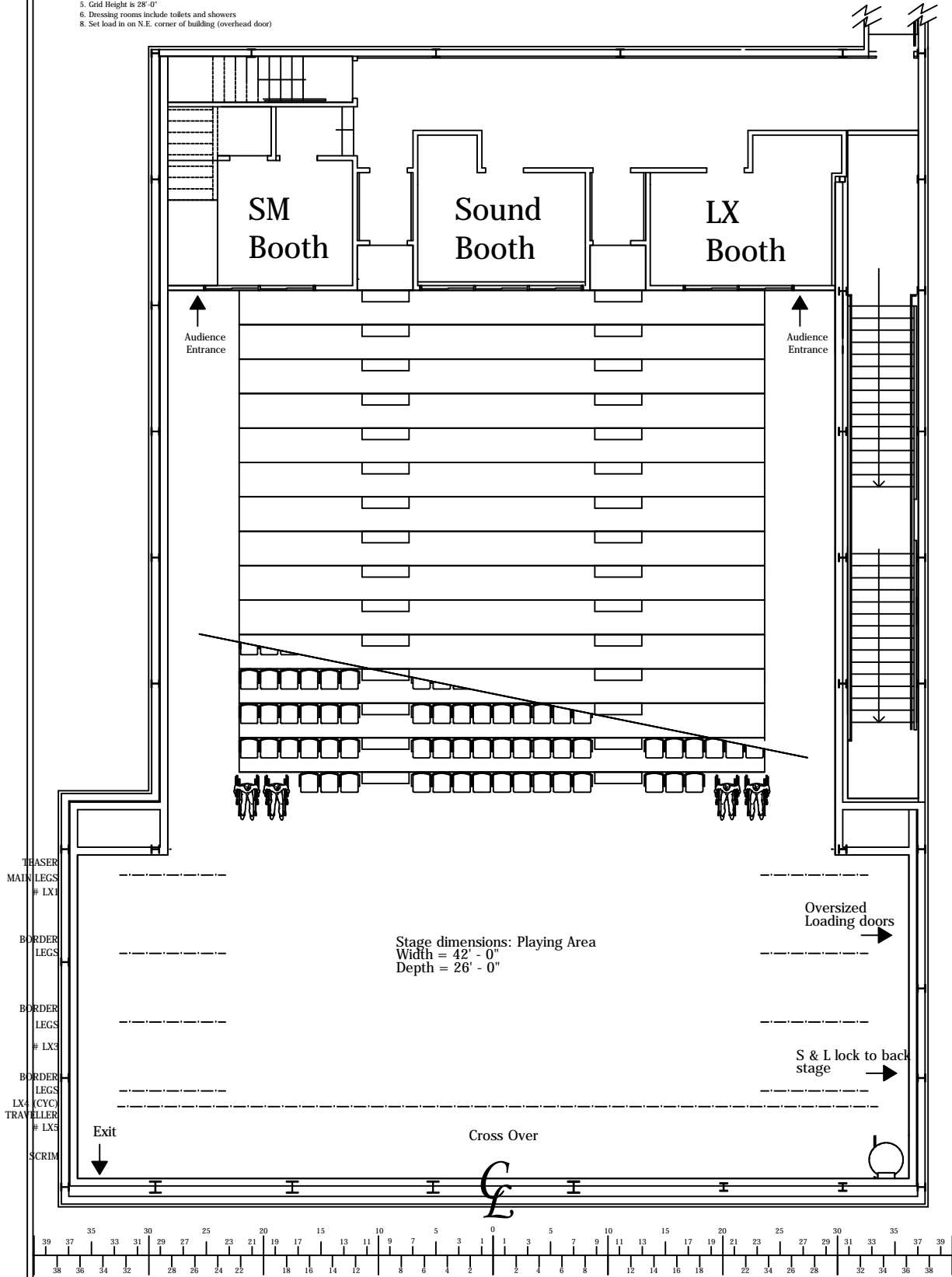

Stage dimensions: Playing Area  
 Width = 42' - 0"  
 Depth = 26' - 0"

Oversized Loading doors

S & L lock to back stage

Cross Over

File: Simple\_westbury.dwg

Scale: NTS

Capacity: ~310

# Westbury Theatre

Proscenium